

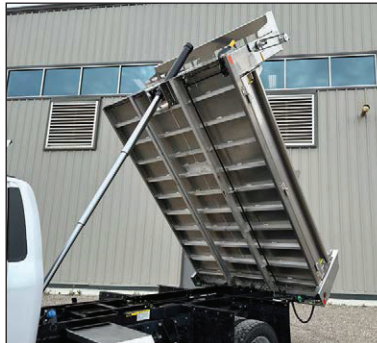

HIGHLIGHTED FEATURES

- Crossmember Channel With Longsills
- Sides - Combination Of Single And Double Wall Design
- Dual Top Lock & Release Mechanism On Tailgate
- Flared Rear Corner Post For Stt Lighting
- Available In Steel Or Aluminum For 60" Ca Or 84" Ca Truck Chassis
- Easy To Mount And Install

The new home of the JOB BOSS, this all steel dump body features a heavy duty crossmember floor, providing maximum support and resistance to twisting or distortion from weight loading. Manufactured in steel and aluminum, the JOB BOSS dump body is supported by the same standard and custom body options offered by Voth Truck Bodies.



| | STEEL | | ALUMINUM | |
|----------------------------------|---|--------|---|--------|
| JOB BOSS SIZE | 9'4" | 11'4" | 9'4" | 11'4" |
| UNDERSTRUCTURE | Crossmembers | | Crossmembers | |
| RECOMMENDED CA | 60" CA | 84" CA | 60" CA | 84" CA |
| HEADBOARD HEIGHT OPTIONS | 55" | | 55" | |
| FOLDING SIDE WALL HEIGHT OPTIONS | 15" | | 15" | |
| FOLDING SIDES | Single | | Single | |
| TAILGATE HEIGHT OPTIONS | 21" | | 21" | |
| FOLDING SIDE MATERIAL | 10 GA Steel 44/50W | | 3/16" Aluminum 5052-H32 | |
| TAILGATE MATERIAL | 10 GA Steel 44/50W | | 3/16" Aluminum 5052-H32 | |
| HEADBOARD MATERIAL | 10 GA Steel 44/50W | | 3/16" Aluminum 5052-H32 | |
| FLOOR MATERIAL | 10 GA Steel 44/50W | | 1/4" Aluminum 5083-H32 | |
| REAR LIGHTING | LED 4 - STT, 2 Reverse, 5 Rear Markers, 2 Front Markers | | LED 4 - STT, 2 Reverse, 5 Rear Markers, 2 Front Markers | |
| WEIGHT RANGE (LBS) | 2210 | 2460 | 1400 | 1525 |

Specs subject to change without notice. Consult with factory for more information.

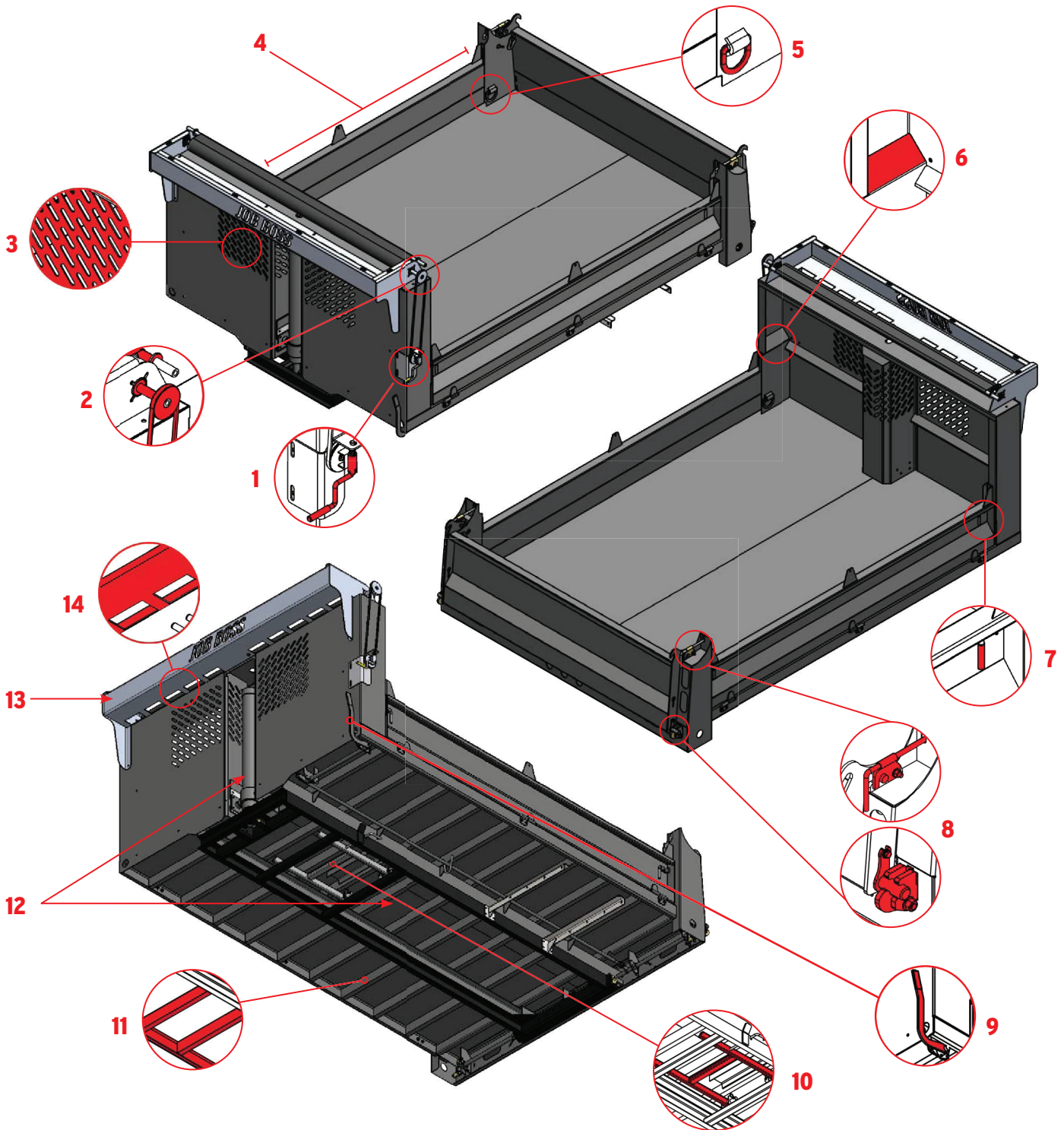

JOB BOSS BODY FEATURES

- | | | |
|---|---|--|
| 1. EASY ACCESS FOLD AWAY/LOCKABLE TARP CRANK | 6. DEBRIS SHEDDING FRONT POSTS | 11. CROSSMEMBER DESIGN FLOOR |
| 2. BLACK HEAVY DUTY MESH TARP WITH STEEL SEALED BEARINGS AND ALL STAINLESS STEEL HARDWARE | 7. STAINLESS STEEL DOOR LATCHES | 12. CHOICE OF EAGLE OR MAILHOT TELESCOPIC CYLINDER OR CHAMPION SCISSOR HOIST |
| 3. CNC CUT WINDOW | 8. TAILGATE LATCHES FOR TWO-WAY ACTING TAILGATE | 13. 9" CABSHIELD |
| 4. POCKETS FOR ALUMINUM OR WOOD SIDE EXTENSIONS | 9. DUMP RELEASE LATCH (TO DUMP) | 14. SHOVEL RACK CUT OUTS INTEGRATED INTO CABSHIELD |
| 5. D-RINGS IN ALL 4 CORNERS | 10. SAFETY STAND | |